



# SUPERTEC

## User Manual

# SUPERTEC

## Tape sling, anchor sling, cowtail

Subject to technical changes

---

### BRIEF DESCRIPTION

---

#### INTENDED USE

The SUPERTEC slings are part of the personal protective equipment (PPE) of Category III to protect against falls from a height. The SUPERTEC slings in combination with a suitable connector or karabiner with a lock (EN 362, EN 12275) serve to create a safe connection between two points of the safety chain, e.g. to anchor a safety line to a permanent structure (e.g. double-T support). SUPERTEC slings serve to secure persons and may not be used as anchors or lifting equipment for loads.

The maximum tensile strength of the slings is determined based on the normative requirements in a static tensile test between two bolts with a defined diameter and smooth surface. Here, the static performance is only tested in an ideal situation and does not take into account all strength-impairing influences that prevail in practice. The user should be aware that the strength may be reduced if used e.g. in an offset position, or if wrapped around profiles with low edge radii.

The SUPERTEC slings have been tested in conjunction with the tape energy absorber BFD MINI edges (>0.5 mm) based on RFU 11.074.

Rated braking load when pulled straight: 30 kN  
Application temperature: -30 °C to +60 °C  
Maximum number of users: 1 Person

**All other uses are deemed improper. The company BORNACK will not be liable for any ensuing damages. The user bears the sole risk.**

#### EQUIPMENT

- Polyamide hose tape fabric
- Polyester yarn
- Connector made of aluminium or steel according to EN 362 for anchor sling and optionally for cowtail

#### USE

- Occupational safety
- Rescue
- Intervention

SUPERTEC tape sling

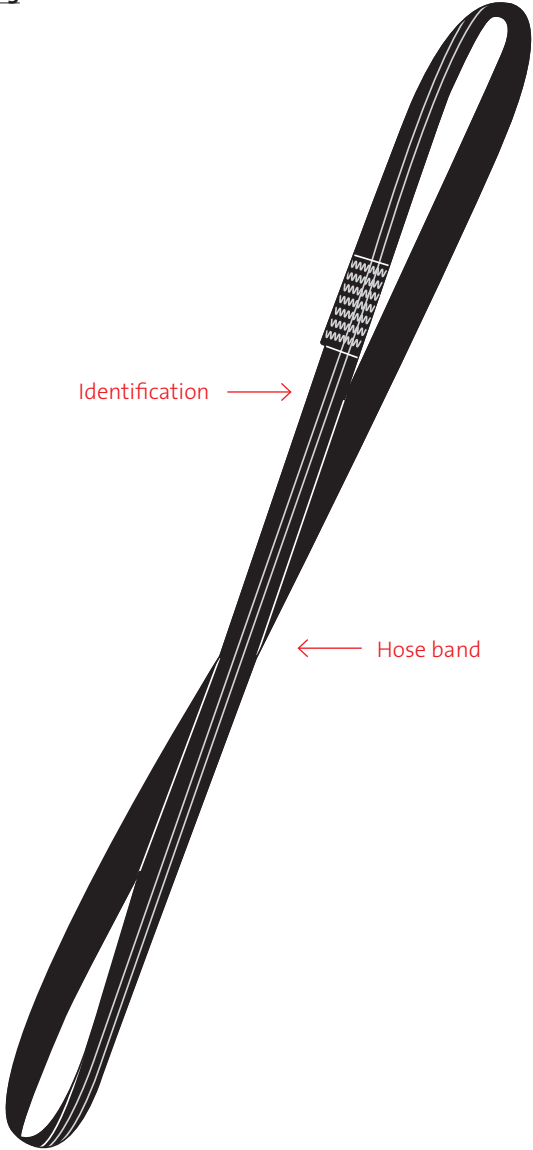

SUPERTEC anchor sling

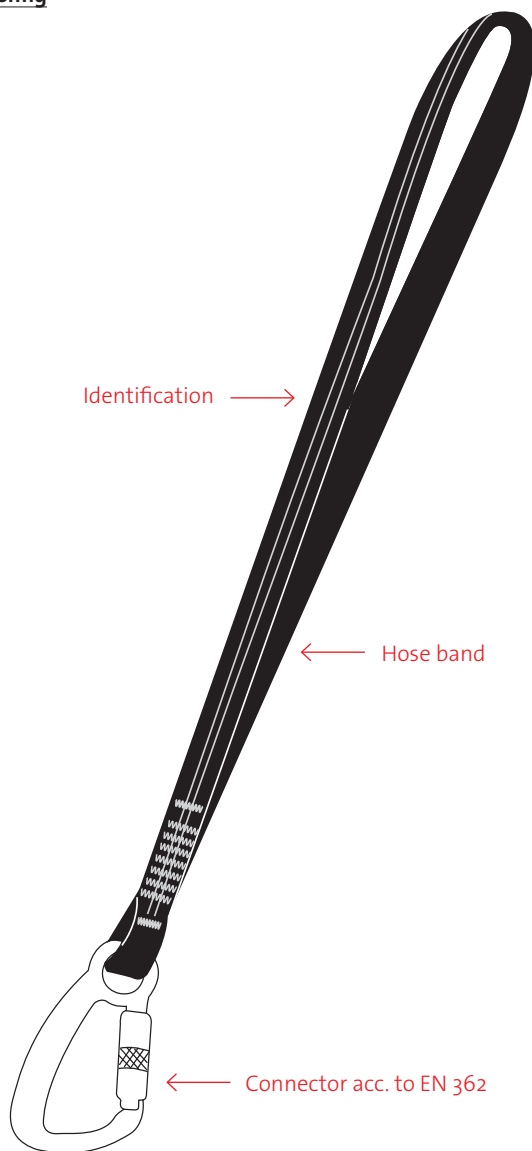

SUPERTEC cowtail

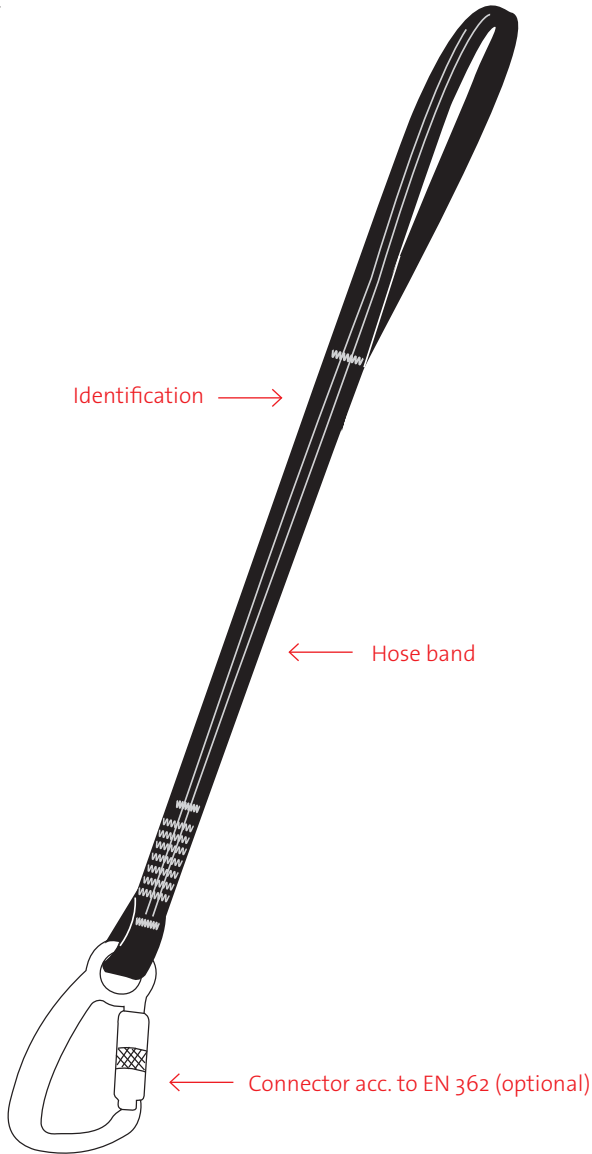

---

## INFORMATION BEFORE USE

---



### Always check before use!

- The personal protective equipment (PPE) may no longer be used in the case of even very minor faults. Faulty PPE components may only be tested or repaired in a workshop authorised in writing by BORNACK.
- If this PPE is used as an arrester system (free fall is possible), only full body harnesses that comply with EN 361 and a tape fall absorber in compliance with EN 355 may be used.

### VISUAL INSPECTION

- Check that the straps are in a flawless condition.
- Check that all seams and strap edges are in a flawless condition.
- Check for damage that can be seen or felt.

## SUPERTEC IN USE

### PREPARATION

#### CAUTION:



Always carry out a risk assessment before commencing work:

- Are there sharp edges/rough surfaces?
- Is there a risk of falling/free fall?
- Take precautions

**A** The building structure (anchor point) must be free of sharp edges or burr. If necessary, use edge protection.

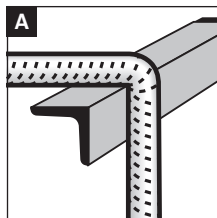

**B** The anchor point for the rope protection must be adequately strong (EN 795); min. 12.0 kN (for one person) in the rope-pull direction. One additional 1.0 kN for each additional person.

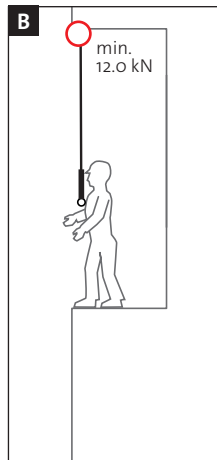

**C** The anchor point must always be 'overhead'. The lanyard slack must be max. 25 % of the length (fall factor < 0.5). Otherwise, only use a cowtail with an energy absorber (BFD) acc. to EN 355 (>0.5 mm).

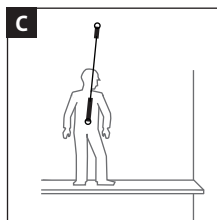

#### CAUTION:



In combination with fall arresters, ensure that the efficiency of the overall system is maintained. Ensure that the total length, including the end connections and connectors, does not exceed 2.0 m.

#### CAUTION: THREAT TO LIFE:



If this PPE is used as an arrester system (free fall is possible), only full body harnesses that comply with EN 361 or EN 12277 may be used.

#### CAUTION:



If wound around less than 10.0 cm, a reduction in the load-bearing force can be expected.

#### CAUTION:



When adjusting the length of the lanyard, avoid places where there is a risk of falling.

## SUPERTEC IN USE

### APPLICATION

#### D Direct attachment, extension and/or relocation

Place the tape sling around a structure. Place both ends into a connector acc. to EN 362. Insert other tape slings into the connector to extend /relocate in compliance with EN 362.

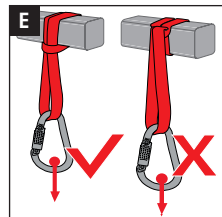
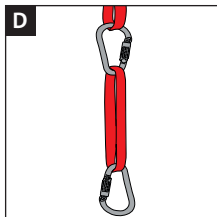

#### E Shortened use

Place the tape sling around a structure. Pull one end of the sling through the loop of the other end (cow hitch).

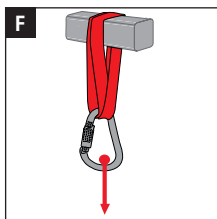

#### F Wrap tape around structure

Place the tape sling around a structure. Place both ends into a connector acc. to EN 362. Once or several times.

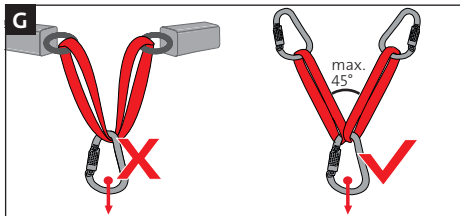

#### CAUTION: THREAT TO LIFE:



If wound around less than 10.0 cm, a reduction in the load-bearing force can be expected (22 kN).

#### CAUTION:



Knots impact on the durability of lanyards. The product is not suitable for knotting.

#### CAUTION:



Do not use in a noose.

#### G Split application

Only with two slings.



---

## SUPERTEC IN USE

---

### COMBINATION

If this product is combined with other components, there is a risk that they mutually impact on operating safety which is why they should only be used and combined in combination with CE-identified and compatible parts of fall protection equipment (p.p.e. against fall from height) and rescue equipment.

If the lanyard is used as part of a fall arresting system, ensure adequate shock absorption to limit the forces exerted during a fall to max. 6 kN. Ensure that the total length of a lanyard connected to an energy absorber (including the end connections and connectors) does not exceed 2.0 m.

**H** Always ensure that, if used with a tape energy absorber, both connecting elements are attached to the anchor point. The free lanyard may never be hung into the full body harness

**I** Two individual lanyards each with a tape energy absorber may not be positioned in parallel.

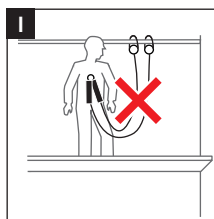
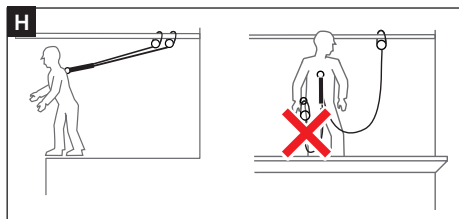

---

## SAFETY INSTRUCTIONS

---

### **There is a risk to life if these safety instructions are not observed!**

- Damaged, fall-stressed, dubious personal protective equipment or safety devices must be immediately withdrawn and not used. The equipment may only be inspected by an expert and/or a workshop authorised in writing by BORNACK. This must be documented in the test card.
- Rope protection is part of the personal fall prevention equipment and should be assigned to a specific person.
- Independent modifications or repairs are not allowed.
- The personal protective equipment may only be used by qualified staff that are familiar with the material. They must be proficient in handling the personal protective equipment and must have been briefed about the possible risks associated with its use.
- Accessories from other manufacturers may only be used if approved by BORNACK and may not impair the function and safety of the protective equipment.
- Clothing and shoes must be suitable for the task at hand and the weather conditions.
- If this PPE is used as an arrester system (free fall is possible), only full body harnesses that comply with EN 361 may be used.
- Only use if fully fit and healthy. Health impairments can jeopardise the safety of the user when working at heights or depths.
- Before using, ensure adequate clearance below the user to prevent impact on a protruding object or the ground.
- Calculation of the possible fall path if all necessary PPE components are used properly: (possibly brake path HSG) + excess lanyard (depending on situation) + brake path fall absorber (max. 1.75 m) + height of D-ring (1.5 m) + safety reserve 1.0 m.
- Before using, ensure adequate clearance below the user to prevent impact on a protruding object or the ground.
- Protect personal protective equipment during storing, use and transportation against the effects of heat (e.g. welding flames or sparks, burning cigarettes) and chemicals (e.g. acids, alkalis, oils, etc.) and mechanical effects (e.g. sharp edges).
- Before starting work, the responsible person must draw up a plan of rescue measures that defines how to rescue casualties quickly and safely and ensures first aid measures. Persons must be rescued within 10 to 30 minutes. BORNACK can help you draw up tailor-made rescue plans and integrate these into specific training courses. [info@bornack.de](mailto:info@bornack.de)
- The local safety guidelines (e.g. in Germany, the DGUV Regulations 198 and 199 by the professional associations) and the accident prevention guidelines for the specific industry (UVV) must be observed.
- Minimise slack line at workplaces where there is a risk of falling.
- Soiling caused by moisture or ice can impact the durability and strength of textile components.

---

## OTHER

---

### **APPROVAL**

Complies with the Ordinance (EU) 2016/425

Type testing and production monitoring by:

TÜV SÜD Product Service GmbH  
Ridlerstr. 65, D-80339 Munich  
CE 0123

Edge test based on RfU 11.074 only in conjunction with BORNACK BFD MINI.

Quality management system certified to DIN EN ISO 9001.

Production monitoring by notified office in accordance with Category III.

### **REGULAR INSPECTIONS**

- This PPE must be inspected by the manufacturer or by an expert at least once a year. The result must be documented in the test card at the end of this User Manual.

### **SALES**

- The dealer must ensure that the User Manual is supplied in the language of the designated country. The respective translation must be authorised by BORNACK.

### **SERVICE**

If you have any further questions about safe use of this PPE or other BORNACK services, such as:

- Risk analysis
- Rescue plans
- Training courses
- Expert inspections

Please send your question to our e-mail hotline: [info@bornack.de](mailto:info@bornack.de)  
We will be happy to help!

### **MAINTENANCE**

- Maintenance may only be carried out by a qualified expert. All instructions in this User Manual must be strictly observed.
- Protective equipment that is well looked after will last longer!

### **CLEANING**

- Dry damp personal protective equipment in the air, not on artificial heat sources. Dry metal components with cloths.
- Clean soiled textile components (e.g. arrester harnesses and ropes) with lukewarm water and a little detergent for delicates. Then rinse carefully and allow to dry in the air. Other cleaning agents are not allowed!
- If disinfection is necessary, please contact the e-mail hotline: [Contact hotline: info@bornack.de](mailto:info@bornack.de)
- If the personal protective equipment comes into contact with saltwater, keep it wet until it can be rinsed with plenty of distilled water.
- If necessary, use compressed air to blow on the unit.

---

## OTHER

---

### LIFE SPAN

**Maximum usage period after being used for the first time:** 8 years

In ideal storage conditions and annual inspections, the product may be stored for up to 3 years before it is used for the first time without impacting on the stated maximum usage period. Every further year in storage reduces the final maximum allowed usage period by 1 year.

Metal parts are not subject to age-related life span deadlines. The expert makes a decision about these parts based on his technical expertise.

For reasons of safety, intensive use and/or extreme application conditions such as sharp edges, chemical influences, UV radiation etc. will reduce the usage period. The company owner needs to take this into account in the workplace risk analysis.

The company owner must ensure compliance with the maximum usage period by documenting first-time use in the test card.

The test card at the end of this user manual must be presented during the regular expert inspections and be completed by an expert.

For more details, please visit is available online at [www.bornack.de](http://www.bornack.de)

### REPAIRS

- For reasons of liability, repairs may only be carried out by the manufacturer.
- Only original spare parts from the manufacturer may be used.

### STORAGE

- Dry damp PPE **before** storage.
- Store in a dry place away from direct sunlight.
- Allowed storage temperature: + 10 °C to + 30 °C
- Do not store PPE near radiators.
- Do not allow personal protective equipment to come into contact with aggressive substances (e.g. oils, grease, acids, chemicals etc.).
- Protected storage in the device case or device bag.











### TRANSPORT

- Protected transport e.g. in the device case or device bag.

OTHER

**PRODUCT IDENTIFICATION**

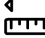
The following identification is on the product:

Product name →	<b>SUPERTEC</b>		← Observe/ read the User Manual
Product type →	<b>Bandschlinge</b>		
Product type →		<b>SUPTEC01/BS/ BK/-</b>	
Article no. →		<b>1004603_C050</b>	
EN norms →	<b>EN 354:2010 EN 566:2017 EN 795-B:2012</b>	<b>CE 0123</b>	← CE symbol
Charge →	 <b>18-1234567</b>		<b>1</b> ← Max. number of users
Serial no. →	 <b>001</b>		<b>30 kN</b> ← Breaking load
Production date →	 <b>12/2018</b>		<b>50 cm</b> ← Length
			↑ Data matrix

Manufacturer address → 

BORNACK GmbH&Co.KG Bustadt 39 74360 Ilfeld/Germany www.bornack.de
--



# TEST CARD

FOR ANNUAL MONITORING

The test list must be completed in full by the expert during the annual inspection.

This test list does not claim to cover all test criteria and does not relieve the expert from his decision about the overall condition.

Type Product name: \_\_\_\_\_

Production date \_\_\_\_\_

Serial no.: \_\_\_\_\_

Purchase date: \_\_\_\_\_

Date of first use: \_\_\_\_\_

Life span end at the latest: \_\_\_\_\_

	Date	Signature	Next Inspection	Reason for inspection
1. year				
2. year				
3. year				
4. year				
5. year				
6. year				
7. year				
8. year				



---

## EU DECLARATION OF CONFORMITY

---



### EU Declaration of Conformity

The manufacturer or his authorised representative established within the EU

BORNACK GmbH & Co. KG  
Bustadt 39  
74360 Ilsfeld  
Germany

hereby declares that the following personal protective equipment

Lanyard / Sling / Anchor device  
**SUPERTEC**

- is in conformity with the relevant harmonisation legislation according to Annex V (Module B) of the Regulation (EU) 2016/425 on personal protective equipment according to Article 19 (category III PPE) and is examined to **EN 354:2010 EN 566:2017 EN 795:2012**
- is identical to the PPE that is the object of the **EU type-examination certificate No. P5A 040506 0300 Rev. 00**

issued by

TÜV SÜD Product Service GmbH  
Zertifizierstelle  
Ridlerstraße 65  
80339 München  
Germany  
CE 0123

- is subject to the assessment of conformity to type, based on internal production control plus supervised product checks according to Module C2 of the Regulation (EU) 2016/425 for personal protective equipment (category III PPE), monitored by the notified body

TÜV SÜD Product Service GmbH  
Zertifizierstelle  
Ridlerstraße 65  
80339 München  
Germany  
CE 0123

20 March 2020

BORNACK GmbH & Co. KG



Ulrike Bornack  
Managing Director







Notes:

A series of horizontal lines for taking notes, starting from the line immediately below the "Notes:" label and extending to the bottom of the page.





### **FALLSTOP**

Safety equipment for securing and rescuing at heights and depths

### **SAFEPOINT**

Permanently installed safety systems for architects and industry

### **BORNACK GmbH & Co. KG**

Bustadt 39  
74360 Ilsfeld  
Germany

Tel + 49 (0) 70 62 / 26 90 0-0  
Fax + 49 (0) 70 62 / 26 90 0-550  
info@bornack.de  
www.bornack.de

